

### 1. Produktmerkmale / Product Features

1	Sonde	Tube
2	Kamarakopf	Camera Head
3	Konsole	Control Box
4	Umschaltknopf	Switch Button
5	Richtungsanzeige Blickwinkel	Indicator Light Direction of View Angle
6	Anschluß	Connector

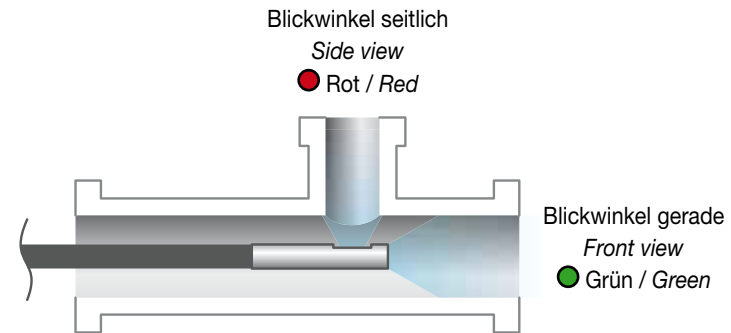

### 2. Inbetriebnahme / Getting Started

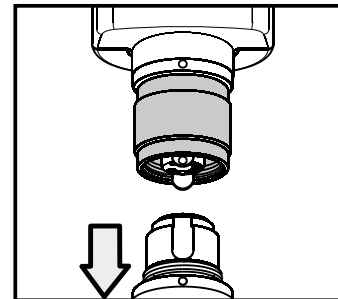



### 3. Technische Daten / Specification

Kamerakopf, Länge	27.4 mm	Camera Head Length
Kamerakopf, Material	Edelstahl rostfrei Stainless steel	Camera Head Material
Sondenlänge	1 m	Probe length
Sondendurchmesser	4.9 mm	Probe diameter
Auflösung	VGA (320 x 240)	Sensor resolution
Lichtquelle gerade: seitlich:	140-224 mcd * 2 LED 210-330 mcd * 2 LED	Light source straight sidewise
Tiefenschärfe	1- 6 cm	DOF (depth of field)
Sichtfeld	Horizontal $\sphericalangle$ 45,2° Vertikal $\sphericalangle$ 34° Diagonal $\sphericalangle$ 56°	FOV (field of view)
Betriebstemperatur	0 °C - 55 °C	Working temperature
Schutzgrad	IP 67	Protection degree
Gewicht	172 g	Weight

### 4. Montage Zubehör / Installing Accessory

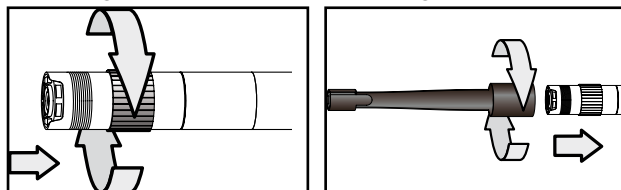

### 5. Sicherheitshinweise / Special Warning

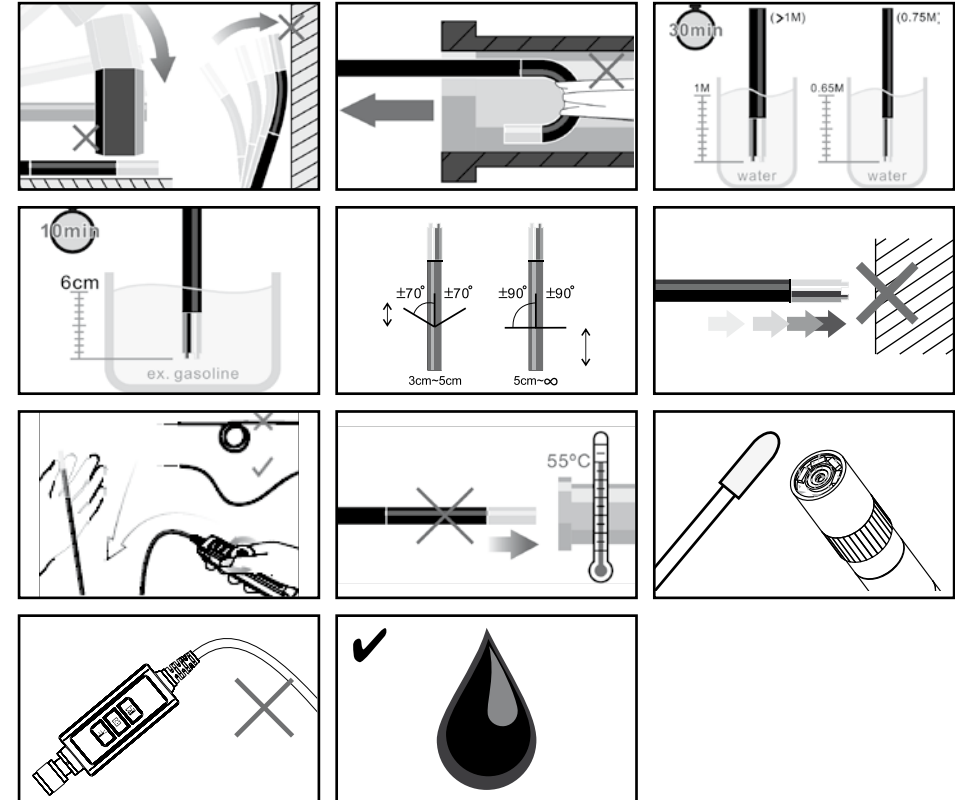

### 6. Lagerung / Storing

