

Betriebsdruck max.  
 Temperaturbereich max.  
 Anwendungsbereich

 60 bar  
 150 °C  
 Pneumatische, ölhydraulische und hydraulische Kreisläufe

255.012

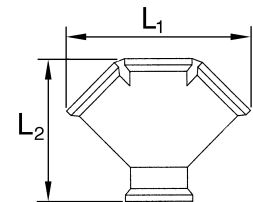
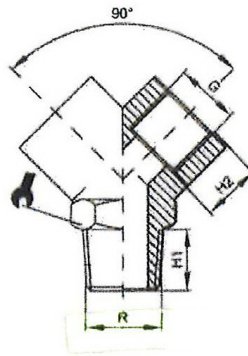

255.212

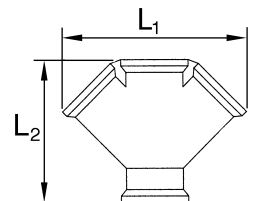
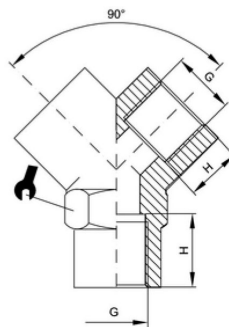
**Verteiler, 2-fach, Messing vernickelt**

Artikel Nr.	Typen Nr.	Gewinde	Abgang	L1 mm	L2 mm	H mm	H1 mm	H2 mm	SW mm
112596	255.00	R 1/8 außen	2 x G 1/8 innen	29,0	32,0	8,0	-	-	13
112597	255.00/1	R 1/4 außen	2 x G 1/4 innen	36,0	38,0	11,0	-	-	17
112598	255.038	R 3/8 außen	2 x G 3/8 innen	41,0	42,5	-	11,5	11,5	20
112599	255.012	R 1/2 außen	2 x G 1/2 innen	53,0	53,0	-	14,0	14,0	25
112600	255.218	G 1/8 innen	2 x G 1/8 innen	29,0	26,5	8,0	-	-	13
112601	255.214	G 1/4 innen	2 x G 1/4 innen	36,0	32,0	11,0	-	-	17
112602	255.238	G 3/8 innen	2 x G 3/8 innen	41,0	37,0	11,5	-	-	20
112603	255.212	G 1/2 innen	2 x G 1/2 innen	53,0	45,0	14,0	-	-	25